

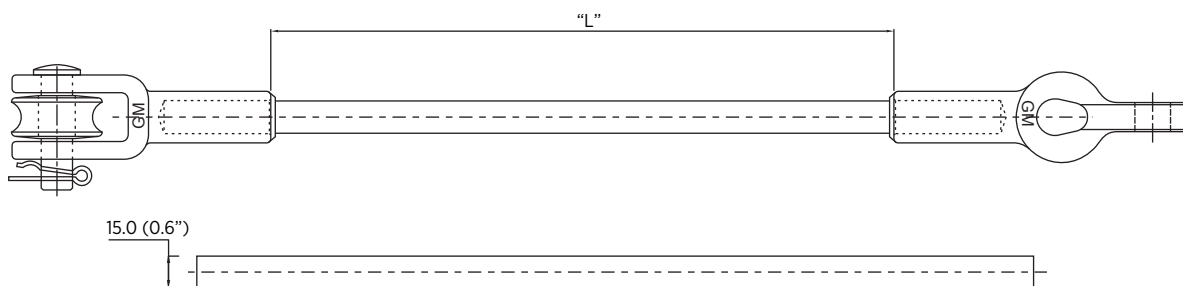

# TENSOR DE FIBRA DE VIDRIO, SERIE GS15

## Fiberglass guy strain Insulators, GS15 - Series



### GS15

| NÚMERO DE CATÁLOGO | Resistencia mecánica, kN | Longitud, mm (pulgadas) |
|--------------------|--------------------------|-------------------------|
| GS1512 - XX        | 67                       | 305 (12")               |
| GS1518 - XX        | 67                       | 457 (18")               |
| GS1524 - XX        | 67                       | 610 (24")               |
| GS1530 - XX        | 67                       | 762 (30")               |
| GS1536 - XX        | 67                       | 914 (36")               |
| GS1542 - XX        | 67                       | 1067 (42")              |
| GS1554 - XX        | 67                       | 1372 (54")              |
| GS1560 - XX        | 67                       | 1524 (60")              |
| GS1578 - XX        | 67                       | 1981 (78")              |
| GS1590 - XX        | 67                       | 2286 (90")              |
| GS1596 - XX        | 67                       | 2438 (96")              |
| GS15120 - XX       | 67                       | 3048 (120")             |
| GS15144 - XX       | 67                       | 3657 (144")             |

| CATALOG NUMBER | Resistencia mecánica, kN | Length, mm (in) |
|----------------|--------------------------|-----------------|
| GS1512 - XX    | 67                       | 305 (12")       |
| GS1518 - XX    | 67                       | 457 (18")       |
| GS1524 - XX    | 67                       | 610 (24")       |
| GS1530 - XX    | 67                       | 762 (30")       |
| GS1536 - XX    | 67                       | 914 (36")       |
| GS1542 - XX    | 67                       | 1067 (42")      |
| GS1554 - XX    | 67                       | 1372 (54")      |
| GS1560 - XX    | 67                       | 1524 (60")      |
| GS1578 - XX    | 67                       | 1981 (78")      |
| GS1590 - XX    | 67                       | 2286 (90")      |
| GS1596 - XX    | 67                       | 2438 (96")      |
| GS15120 - XX   | 67                       | 3048 (120")     |
| GS15144 - XX   | 67                       | 3657 (144")     |

**Nota 1:** El código XX hace referencia a los herrajes en cada terminal del aislador.

**T:** Thimble eye.

**Y:** Y - Clevis.

**C:** Clevis con pin y clip.

**R:** Clevis con roller pin y clip.

Ejemplo: TC (Thimble eye - Clevis con pin y clip)

**Note 1:** XX code is the type of cast iron, hot dip galvanized end fittings.

**T:** Thimble eye.

**Y:** Y - Clevis.

**C:** Clevis with pin and clip.

**R:** Clevis with roller pin and clip.

Example: TC (Thimble eye - Clevis with pin and clip) end.